

FLO-ET® FLOW CONTROLS



REDUCE WATER CONSUMPTION AND INCREASE YOUR SAVINGS

Clack offers a full line of Flo-et® flow controls that provide an easy, efficient way to reduce water usage, water waste and energy consumption in a wide range of liquid handling systems.

With every increase in energy costs, Flo-et flow controls offer increased cost efficiency.

These simple to install units can control liquid flow rates from .25 gpm to 540 gpm, between 20-120 PSID. They are ideal for applications that require tamper-proof volume regulation and pressure equalization.

Flo-et inserts are constructed of corrosion-resistant, molded material for maximum dependability and minimum maintenance to fit most flow regulation needs.

For residential, commercial or industrial applications, Flo-et flow controls provide more accurate, reliable and economical liquid flow control.

FLO-ET® FLOW CONTROLS

Clack Flo-et flow controls offer many advantages over conventional valve type flow controls.

Initially, Flo-et controls cost less to install. And, because they require no maintenance, they maximize cost savings over the life of your equipment.

Flo-et flow controls are completely tamper-proof, yet authorized persons can easily alter them for increases or decreases in the flow rate.

Clack offers a wide range of customized Flo-et inserts to meet your exact application needs. Both Flo-et inserts and retainers are ideal for incorporation into custom-designed housings. This provides additional cost savings by eliminating the need to purchase the housing. Because of our unique design Clack can offer you the option to purchase only the Flo-et insert or the insert and the retainer.

SPECIFICATIONS

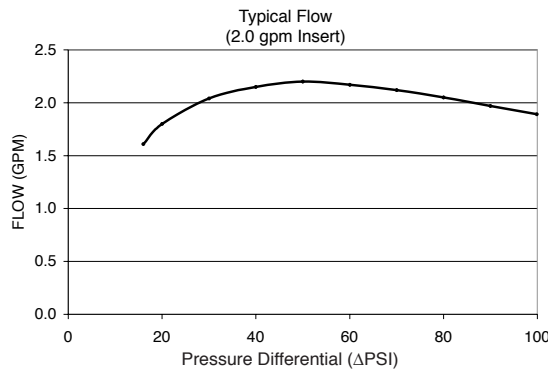

Normal Operating Temperature Range
40° to 140° F (5° to 60° C)

Normal Operating Pressure Range
20 to 120 psi (1.4 - 8.4 Kg. per Sq Cm.)

INSERTS

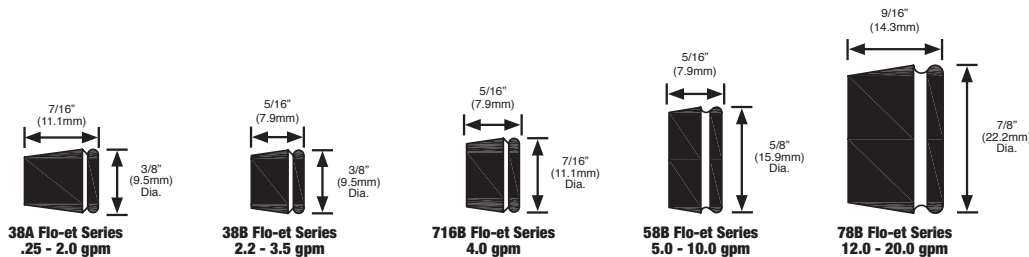

Order No.	Description
V7B21A.25N	38A-3-47 0.25 gpm
V7B21A0.4N	38A-4-47 0.40 gpm
V7B21A0.5N	38A-4-57 0.50 gpm
V7B21A0.6N	38A-5-46 0.60 gpm
V7B21A0.7N	38A-5-47 0.70 gpm
V7B21A0.8N	38A-5-57 0.80 gpm
V7B21A0.9N	38A-6-47 0.90 gpm
V7B21A1.0N	38A-6-57 1.0 gpm
V7B21A1.2N	38A-7-47 1.2 gpm

Order No.	Description
V7B21A1.4N	38A-7-52 1.4 gpm
V7B21A1.6N	38A-8-47 1.6 gpm
V7B21A1.8N	38A-8-52 1.8 gpm
V7B21A2.0N	38A-8-57 2.0 gpm
V7B22A2.2N	38B-9-52 2.2 gpm
V7B22A2.5N	38B-9-57 2.5 gpm
V7B22A3.0N	38B-10-57 3.0 gpm
V7B22A3.5N	38B-10-62 3.5 gpm

Order No.	Description
V7B42A4.0N	716B-11-62 4.0 gpm
V7B62B5.0	58B-13-535 5.0 gpm
V7B62B6.0	58B-14-568 6.0 gpm
V7B62B7.0	58B-15-568 7.0 gpm
V7B62B8.0	58B-16-568 8.0 gpm
V7B62B9.0	58B-16-602 9.0 gpm
V7B62B10	58B-17-602 10 gpm
V7B82B12	78B-20-58 12 gpm
V7B82B15	78B-22-62 15 gpm
V7B82B20	78B-24-74 20 gpm

Note: Special flow rates can be designed upon request.

RETAINERS

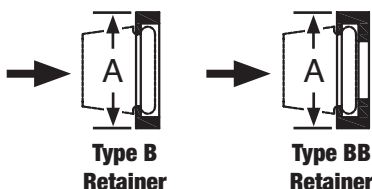

Type B retainer is intended for a press fit into a housing or adapter that provides back-up support for the Flo-et insert. The BB type can be used in a housing or adapter that does not provide back-up support.

Order No.	Description	"A" Dimension		For Insert Series No.
		Inches	Millimeters	
V7C22B3	38R-1BB Brass	.463-.465	11.7-11.8	38A & 38B
V7C22C3	38R-1BB PVC	.463-.465	11.7-11.8	38A & 38B
V7C21B5	38R-2B Brass	.525-.527	13.3-13.4	38A & 38B
V7C22C6	38R-4BB PVC	.787-.789	20.0-20.1	38A & 38B
V7C62C6	58R-2BB PVC	.787-.789	20.0-20.1	58B
V7C62C8	58R-4BB CPVC	.995-.997	25.2-25.3	58B
V7C82B8	78R-2BB Brass	.995-.997	25.2-25.3	78B

RESIDENTIAL AND LIGHT COMMERCIAL

Clack offers a wide range of Flo-et flow controls that are ideal for use in private homes and buildings.

Water flow rate can be equalized throughout the home or building by installing a Flo-et at the inlet to each appliance. And water usage can be reduced substantially by controlling the volume of water used

in sinks, showers, and drinking fountains.

Flo-et flow controls can be incorporated into inline housings for specific contact time with point-of-use water filters.

Residential and light commercial Flo-et flow controls are available in flow rates from .25 to 20 gpm.

FLO-ET FLOW CONTROLS

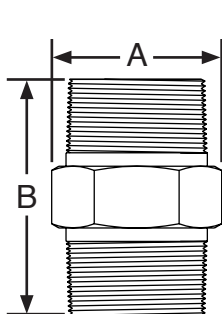

Fig. 1

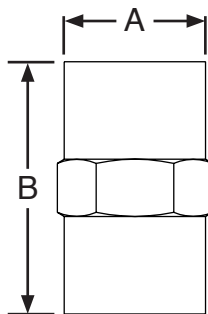

Fig. 2

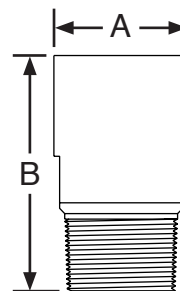

Fig. 3

ORDER NUMBER	DESCRIPTION	AVAILABLE FLOW RATES	PIPE SIZE	A IN. (MM)	B IN. (MM)	FLOW DIRECTION	HOUSING MATERIAL	FIGURE
V7A053C-FM	76- 1A 1/2" PVC Flow Control Female to Male	.25 - 3.5 gpm	1/2"	1-1/2" Dia. (38.1mm)	1-3/4" (44.5mm)	F-M	Type 1, Grade PVC	3
V7A053C-MF	76- 1A 1/2" PVC Flow Control Male to Female	.25 - 3.5 gpm	1/2"	1-1/2" Dia. (38.1mm)	1-3/4" (44.5mm)	M-F	Type 1, Grade PVC	3
V7A056D*	83-46C 1/2" SS Flow Control	.25 - 3.5 gpm 5 - 10 gpm	1/2"	1" Hex (25.4mm)	1-7/8" (47.6mm)	F-F	Stainless Steel	2
V7A071B*	70-CN25 3/4" B Flow Control	.25 - 3.5 gpm 5 - 10 gpm	3/4"	1-3/32" Hex (27.8mm)	1-3/4" (44.5mm)	M-M	Brass	1
V7A076D*	78-111 3/4" SS Flow Control	.25 - 3.5 gpm 5 - 10 gpm	3/4"	1-1/4" Hex (31.8mm)	2" (50.8mm)	F-F	Stainless Steel	2
V7A106D	78-109 1" SS Flow Control	5.0 - 20 gpm	1"	1-1/2" Hex (38.1mm)	2-3/4" (69.9mm)	F-F	Stainless Steel	2

*Note: This assembly is not available with a 4.0 gpm insert.

COMMERCIAL / INDUSTRIAL

Clack Commercial/Industrial Flo-ets provide flow control in a variety of applications, including multi-story buildings, water treatment equipment, cooling towers, and agricultural systems.

These highly efficient flow controls are available in flow rates from 15 gpm to 540 gpm. The body of the Commercial/Industrial Flo-et is a galvanized steel nipple with a PVC Retainer Plate, with sizes from 2 inches to 6 inches in diameter.

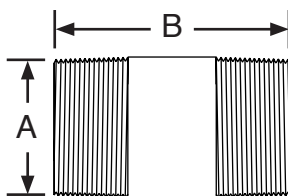

ORDER NUMBER	A		B		APPROXIMATE WEIGHT		STATE FLOW WHEN ORDERING		NO. OF INSERTS EACH
	NPT U.S. INCHES	CENTI-METERS	U.S. INCHES	CENTI-METERS	U.S. LBS.	KILOGRAM	U.S. GALLONS PER/MIN	LITERS PER/MIN	
V7A201G1A	2"	5.08	4"	10.2	1.5 lbs.	.68 Kg	15-70	57-264	7
V7A301G1A	3"	7.62	4-1/2"	11.4	2.75 lbs.	1.25 Kg	70-140	264-530	14
V7A401G1A	4"	10.16	5"	12.7	4.75 lbs	2.15 Kg	125-250	473-946	25
V7A601G1A	6"	15.24	5-1/2"	14.0	8.75 lbs	3.97 Kg	270-540	1022-2044	54

PVC FLO^{ET} → FLOW CONTROLS

Clack PVC flow controls are designed for applications where constant flow rates are required and variable pressures are encountered. They are ideal for use in environments where metal housings are not recommended, such as high purity, deionized water applications. Flow capacities are available from .25 gpm to 540 gpm.

INSERT ORDER NO.	FLOW RATE (GPM)	COLOR CODE	MATERIAL
V7B21A.25N	0.25	Black (not color coded)	Buna S
V7B21A0.4N	0.40		
V7B21A0.5N	0.50		
V7B21A0.6N	0.60		
V7B21A0.7N	0.70		
V7B21A0.9N	0.90		
V7B21A1.0N	1.0		
V7B21A1.2N	1.2		
V7B21A1.4N	1.4		
V7B21A1.6N	1.6		
V7B21A1.8N	1.8		
V7B21A2.0N	2.0		
V7B22A2.2N	2.2		
V7B22A2.5N	2.5		
V7B22A3.0N	3.0		
V7B22A3.5N	3.5		
V7B62B5.0	5.0	Blue	Buna N
V7B62B6.0	6.0	Red	
V7B62B7.0	7.0	Brown	
V7B62B8.0	8.0	Green	
V7B62B9.0	9.0	Tan	
V7B62B10	10	Orange	
V7B82B12	12	Black (not color coded)	
V7B82B15	15		
V7B82B20	20		
V7B62B0.0	0.0		

FLOW RATE (GPM)	NO. OF INSERTS	PIPE SIZE (in.)	THREADED NPT			
			ORDER NO. WITH INSERTS	ORDER NO. HOUSING ONLY	LENGTH "A" (INCHES)	APPROX. WEIGHT LBS.
0.25-3.5	1	1/2	V7A051C1	V7D051C1	2	0.05
0.25-3.5	1	3/4	V7A071C1	V7D071C1	2	0.06
5-10	1	3/4	V7A071C1-02	V7D071C1-02	2	0.06
5-10	1	1	V7A101C1	V7D101C1	3	0.12
12,15,20	1	1	V7A101C1-01	V7D101C1-01	3	0.12
10-20	2	1-1/4	V7A121C1	V7D121C1	3	0.18
20-40	4	1-1/2	V7A151C1	V7D151C1	3	0.25
35-70	7	2	V7A201C1	V7D201C1	3	0.31
45-90	9	2-1/2	V7A251C1	V7D251C1	4	0.56
70-140	14	3	V7A301C1	V7D301C1	4	0.68
125-250	25	4	V7A401C1	V7D401C1	4	1.00
270-540	54	6	V7A601C1	V7D601C1	4	2.50

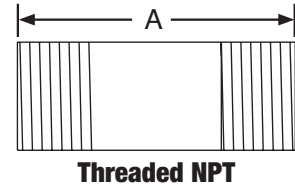

FLOW RATE (GPM)	NO. OF INSERTS	PIPE SIZE (in.)	PLAIN END			
			ORDER NO. WITH INSERTS	ORDER NO. HOUSING ONLY	LENGTH "A" (INCHES)	APPROX. WEIGHT LBS.
0.25-3.5	1	1/2	V7A052C1	V7D052C1	5	0.09
0.25-3.5	1	3/4	V7A072C1	V7D072C1	5	0.12
5-10	1	3/4	V7A072C1-02	V7D072C1-02	5	0.12
5-10	1	1	V7A102C1	V7D102C1	5	0.18
12,15,20	1	1	V7A102C1-01	V7D102C1-01	5	0.18
10-20	2	1-1/4	V7A122C1	V7D122C1	5	0.27
20-40	4	1-1/2	V7A152C1	V7D152C1	5	0.36
35-70	7	2	V7A202C1	V7D202C1	5	0.47
45-90	9	2-1/2	V7A252C1	V7D252C1	5	0.80
70-140	14	3	V7A302C1	V7D302C1	5	1.00
125-250	25	4	V7A402C1	V7D402C1	5	1.47
270-540	54	6	V7A602C1	V7D602C1	5	3.90

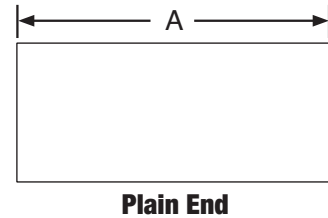

FLOW RATE (GPM)	NO. OF INSERTS	PIPE SIZE (in.)	FLANGED			
			ORDER NO. WITH INSERTS	ORDER NO. HOUSING ONLY	LENGTH "A" (INCHES)	APPROX. WEIGHT LBS.
5-10	1	3/4	V7A079C1-02	V7D079C1-02	5	0.68
12,15,20	1	1	V7A109C1-01	V7D109C1-01	6	0.96
20-40	4	1-1/2	V7A159C1	V7D159C1	6	1.64
35-70	7	2	V7A209C1	V7D209C1	6	2.43
45-90	9	2-1/2	V7A259C1	V7D259C1	6	3.80
70-140	14	3	V7A309C1	V7D309C1	6	4.76
125-250	25	4	V7A409C1	V7D409C1	6	7.55
270-540	54	6	V7A609C1	V7D609C1	8-1/2	12.60

